

---

ATHLETICS DEPARTMENT  
FACILITIES MASTER PLAN

UNIVERSITY OF LOUISIANA  
*at Lafayette*

---

MARCH . 2013

“This plan is the most important thing the Athletics Department has done in 50 years related to our facilities.”

-Scott Farmer, Director of Athletics

- Process began August 1<sup>st</sup> 2012
- 21 separate programming meetings
- 35 individuals from the University and Athletics





- Cutting-edge facilities
- Facilities and grounds maintenance plan
- Recruiting opportunities
- Improved connection to campus
- Plan for future expansion
- Athletic community/village





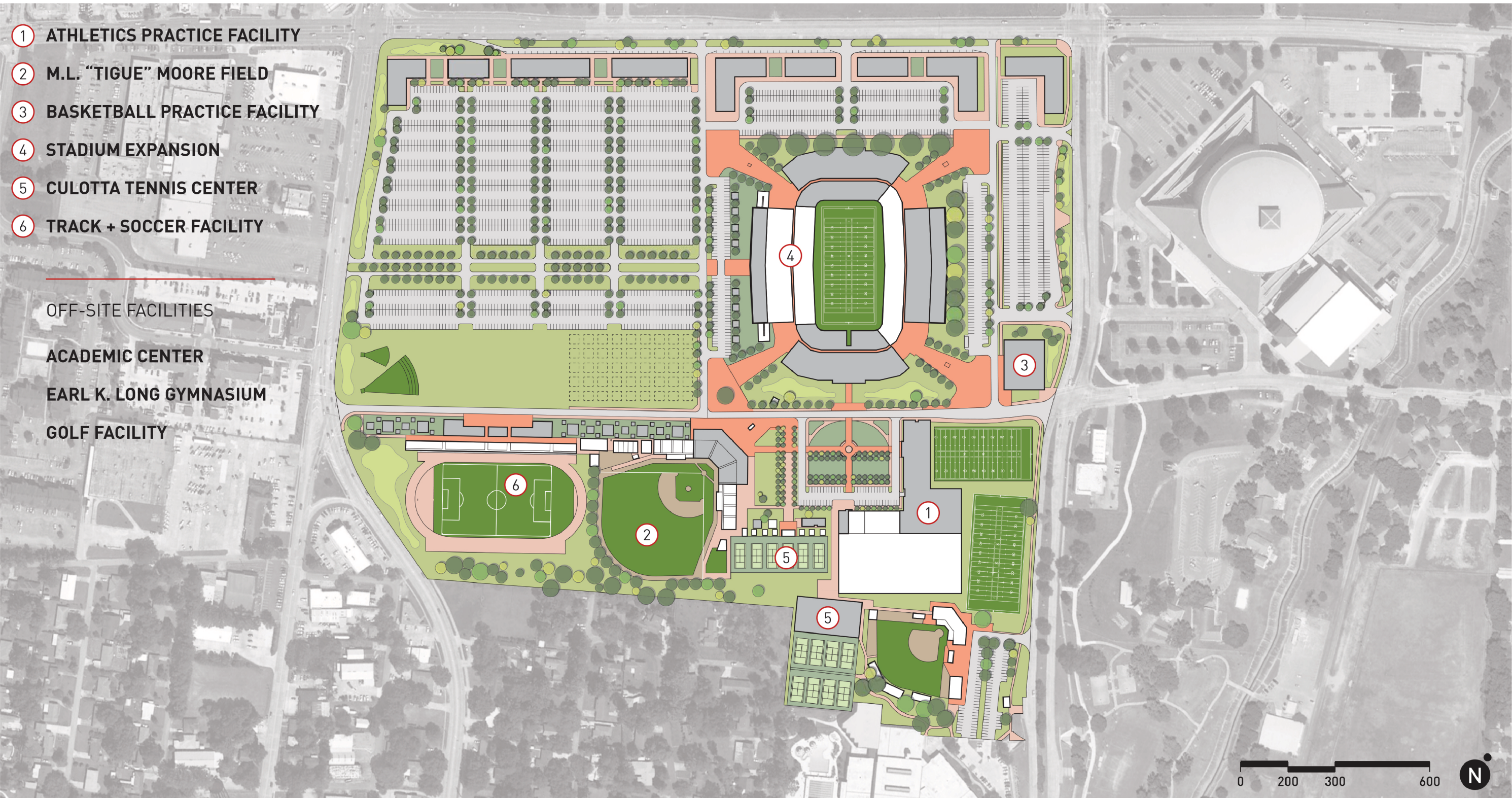

- 1 ATHLETICS PRACTICE FACILITY
- 2 M.L. "TIGUE" MOORE FIELD
- 3 BASKETBALL PRACTICE FACILITY
- 4 STADIUM EXPANSION
- 5 CULOTTA TENNIS CENTER
- 6 TRACK + SOCCER FACILITY

OFF-SITE FACILITIES

ACADEMIC CENTER

EARL K. LONG GYMNASIUM

GOLF FACILITY

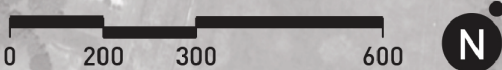



# ACADEMIC CENTER



# ACADEMIC CENTER



- A campus destination for Athletics
- Anticipates growth of Department
- 50-station computer lab
- 14 tutorial rooms and study hall
- Classroom and quiet study space



# ATHLETICS PRACTICE FACILITY

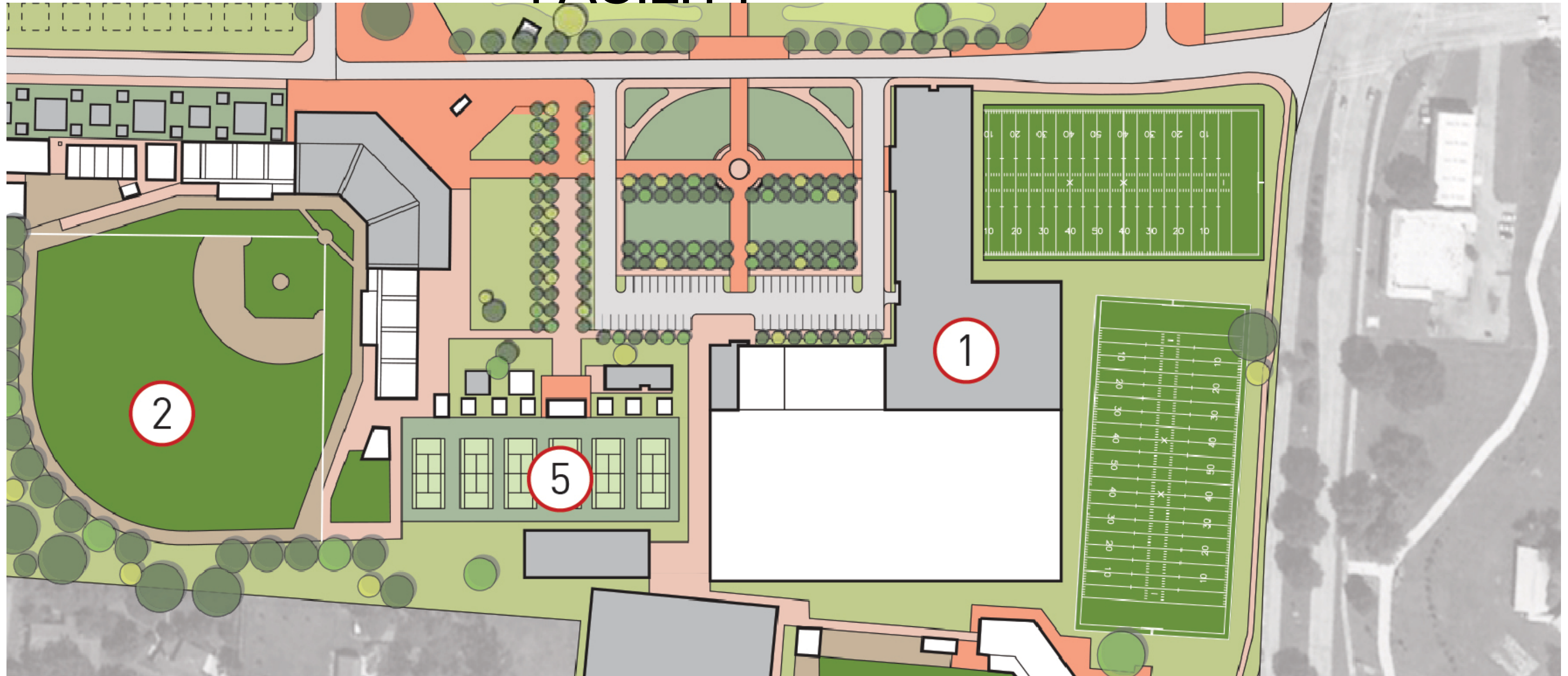

# ATHLETICS PRACTICE FACILITY



- Offices of Ragin' Cajuns Football Staff
- Training facility for all sports
- Direct access into Moncla Facility
- Frames new Sports Plaza
- 70,000 SF facility







# M. L. TIGUE MOORE FIELD

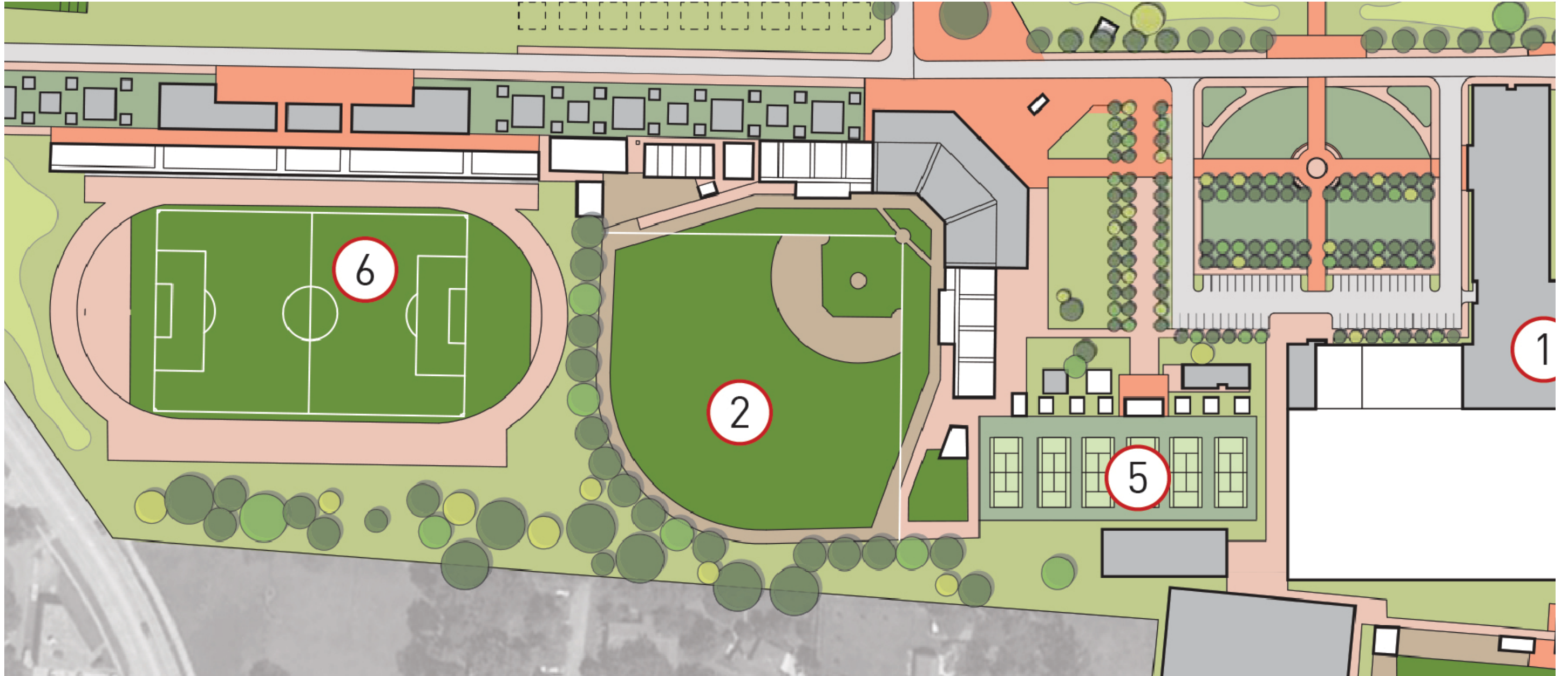

# M. L. TIGUE MOORE FIELD

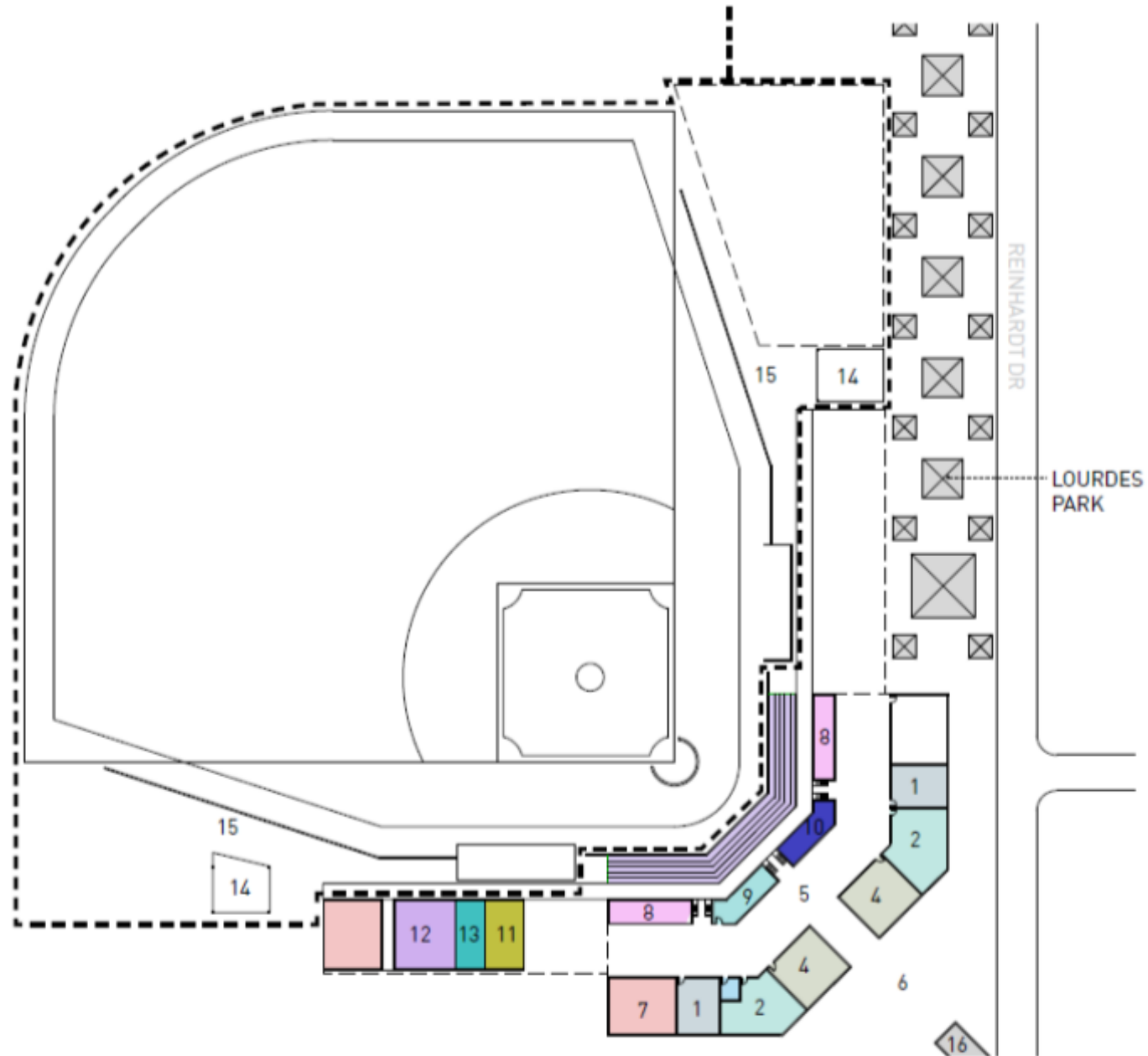

- New chairback seating at home plate
- Unifies 1<sup>st</sup> and 3<sup>rd</sup> base bleachers
- New spectator amenities
- New clubhouse and coaches offices
- Expanded Lourdes Park

# M. L. TIGUE MOORE FIELD

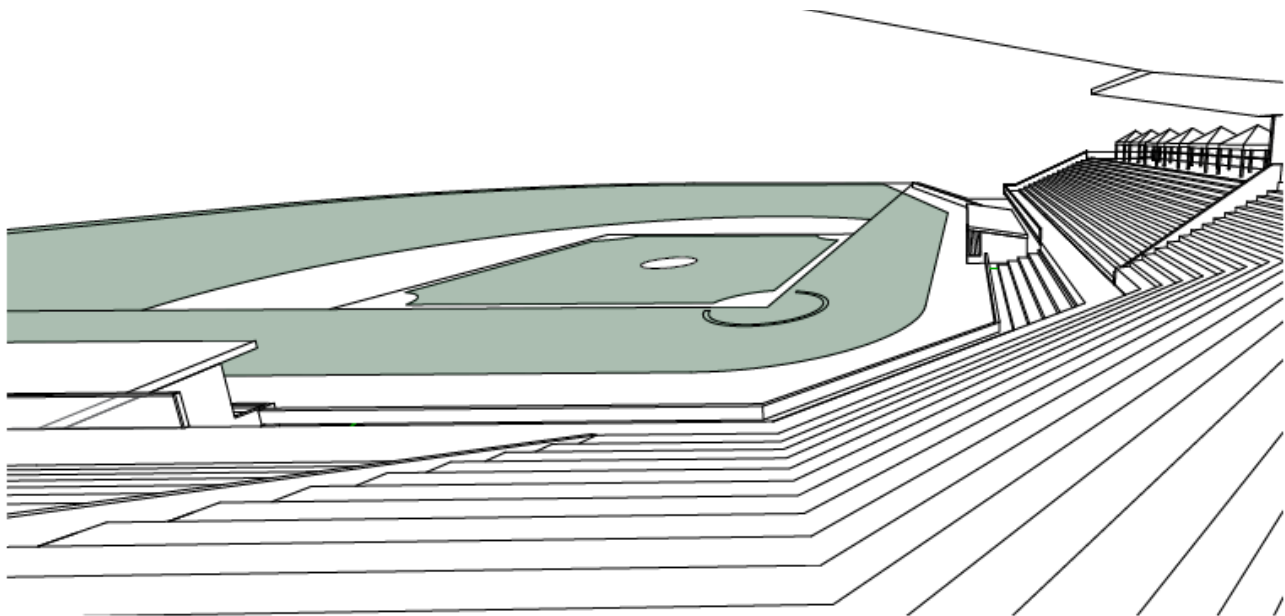

**M.L. TIGUE MOORE STADIUM EXPANSION**  
3D VIEW

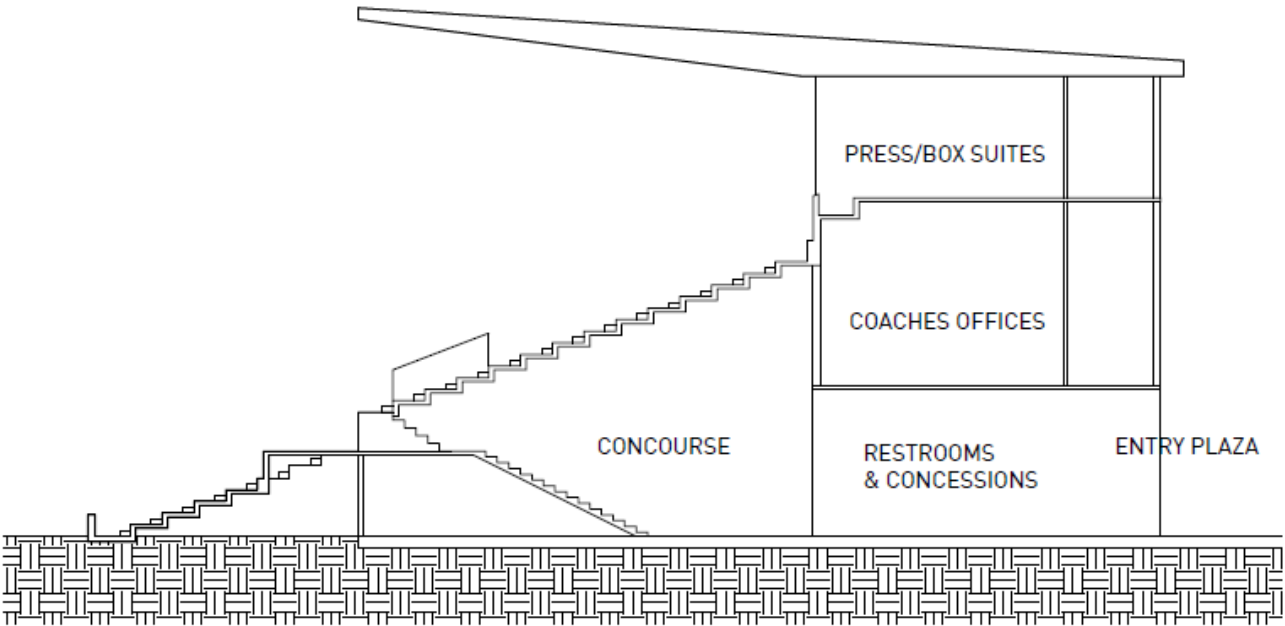

**M.L. TIGUE MOORE STADIUM EXPANSION**  
3D VIEW

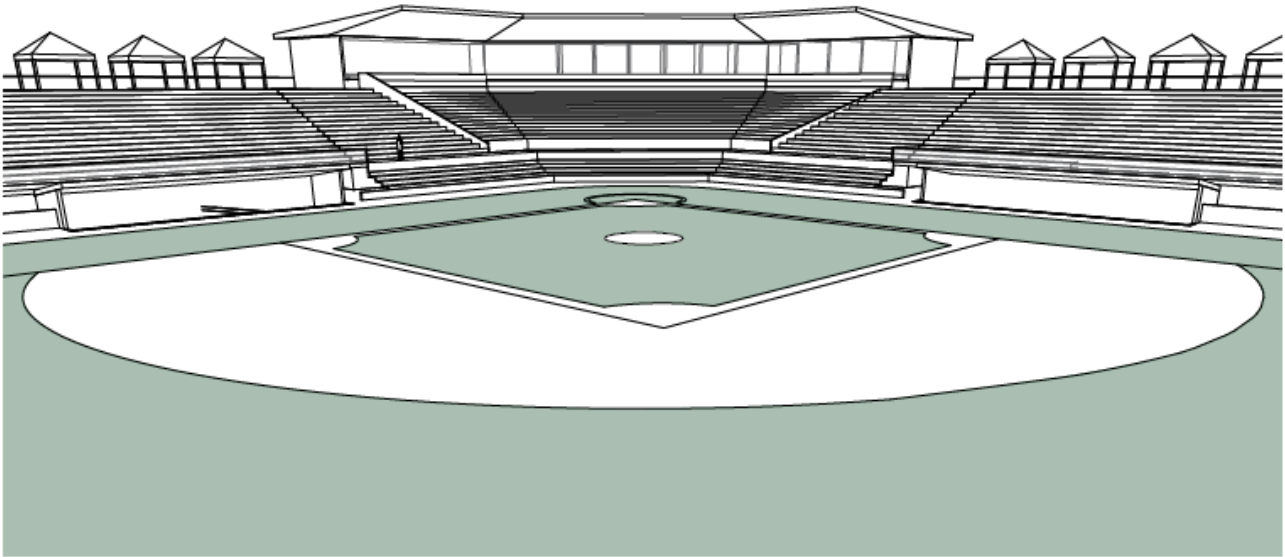
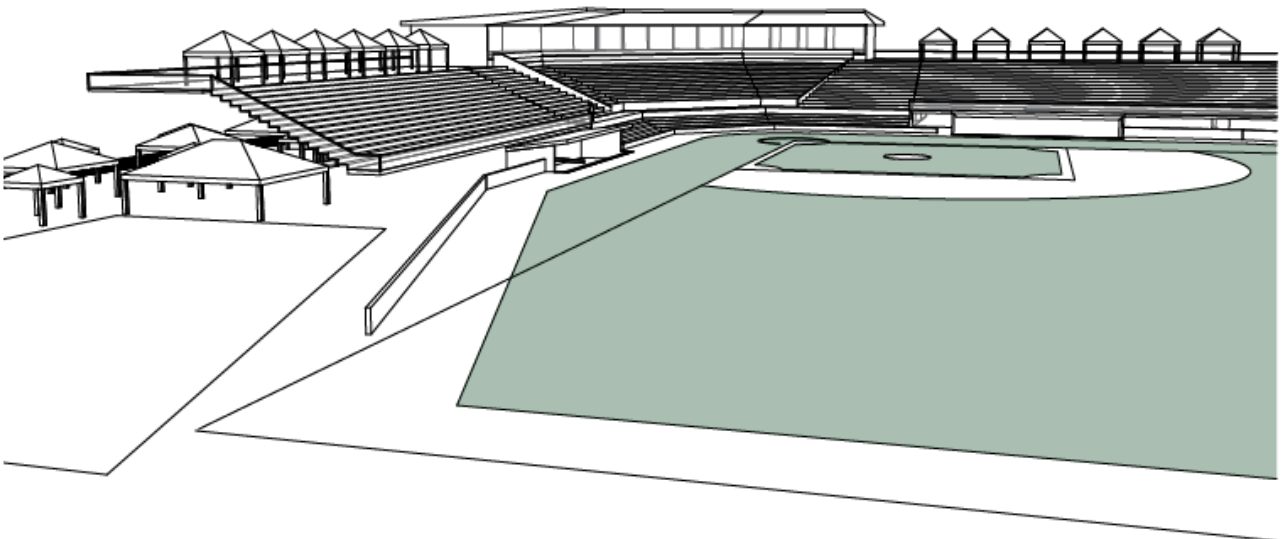



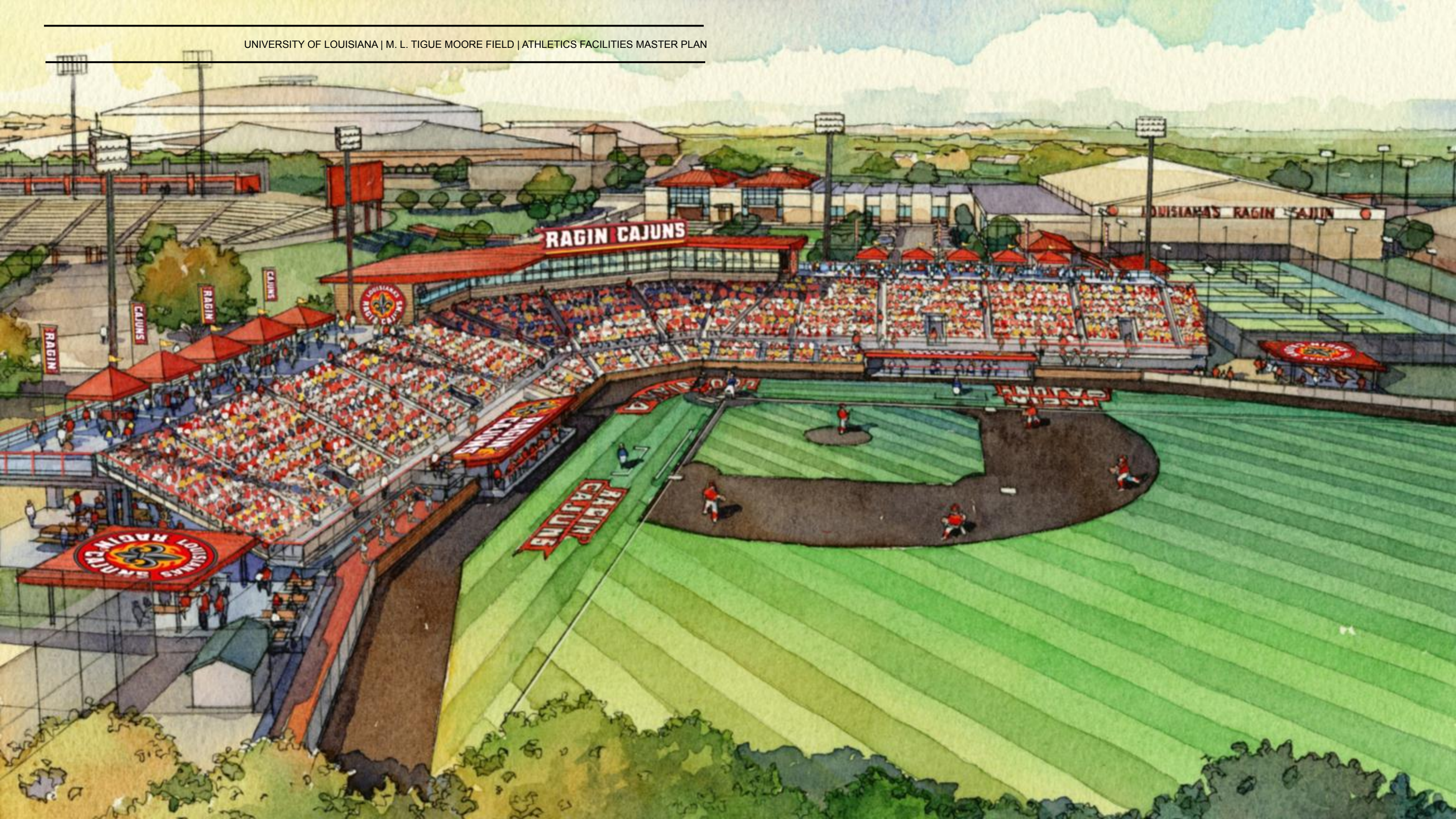



# BASKETBALL PRACTICE FACILITY

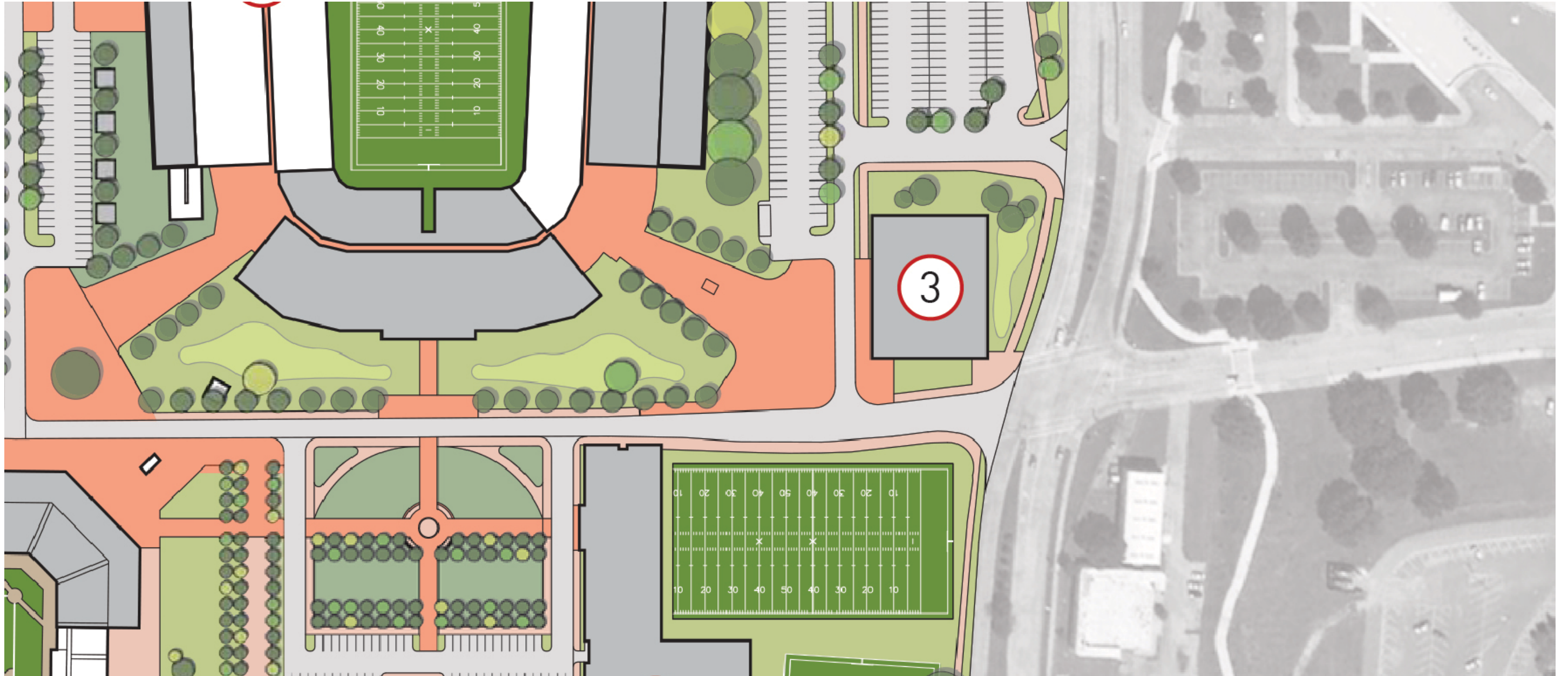

# BASKETBALL PRACTICE FACILITY

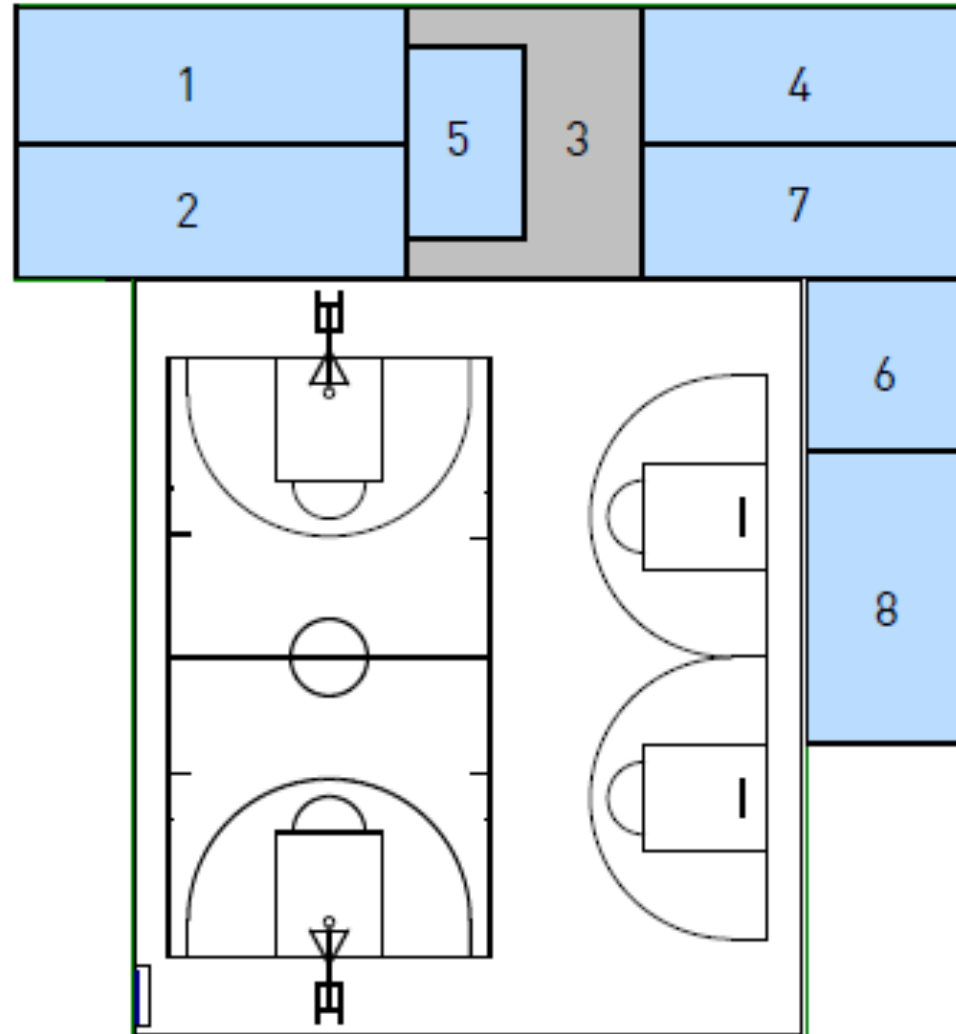

- Training Facility & Offices for Ragin' Cajuns Basketball
- Equal facilities for men and women
- Shared practice court
- New coaches office suites
- 26,000 SF facility



# STADIUM EXPANSION

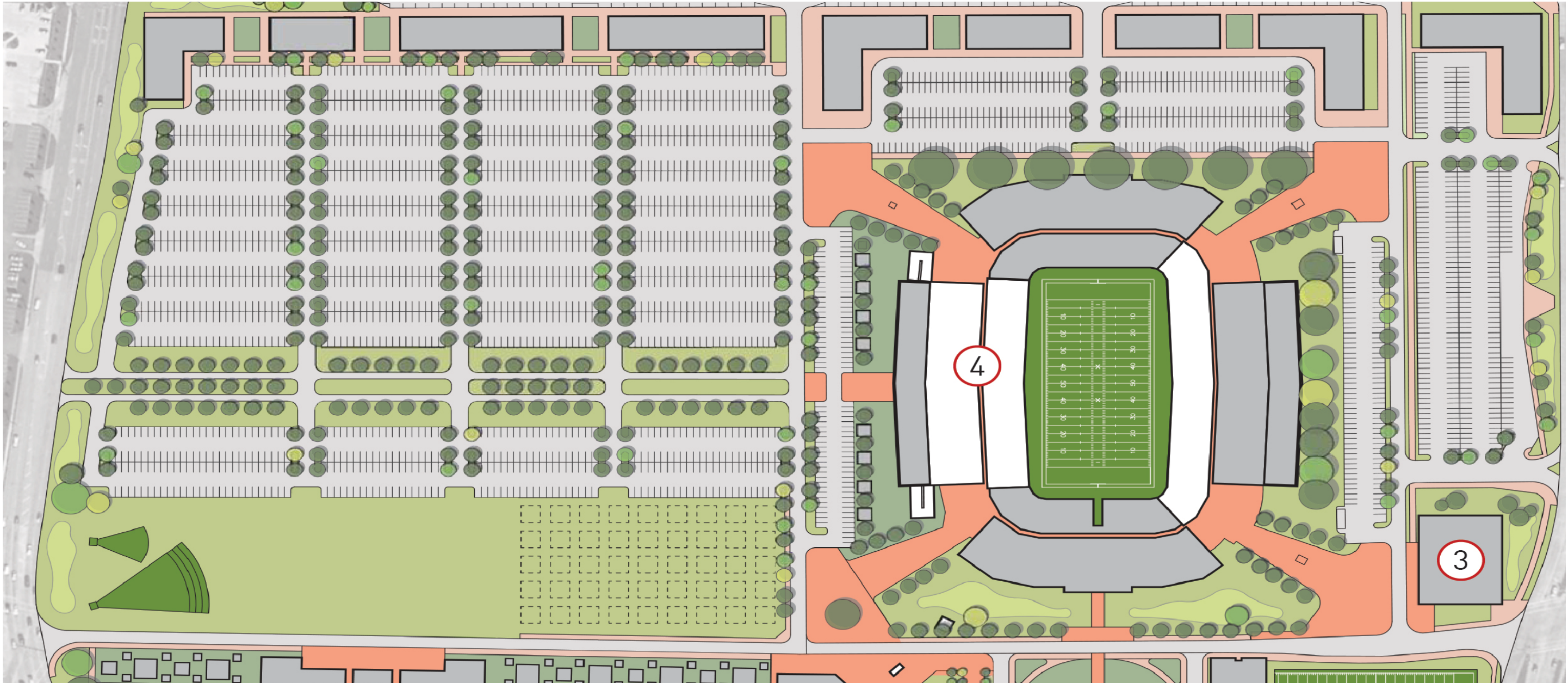

# STADIUM EXPANSION

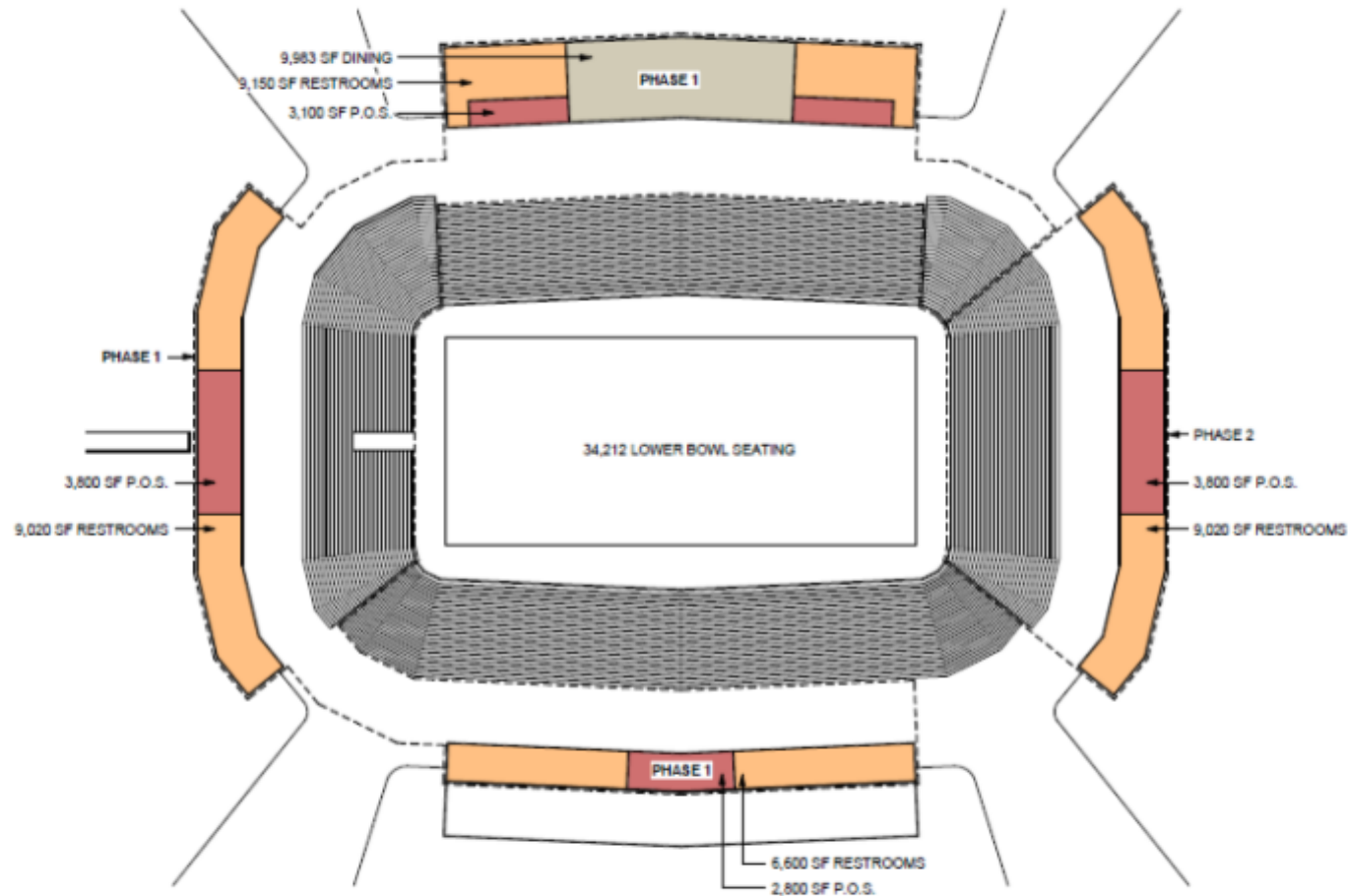

- Administrative offices for Ragin' Cajuns Athletics
- Improved facilities and amenities for fans
- Multi-phase expansion plan
- Phase 1 focused on revenue
- New press box facilities
- Projected 62,000+ seat stadium



# STADIUM EXPANSION

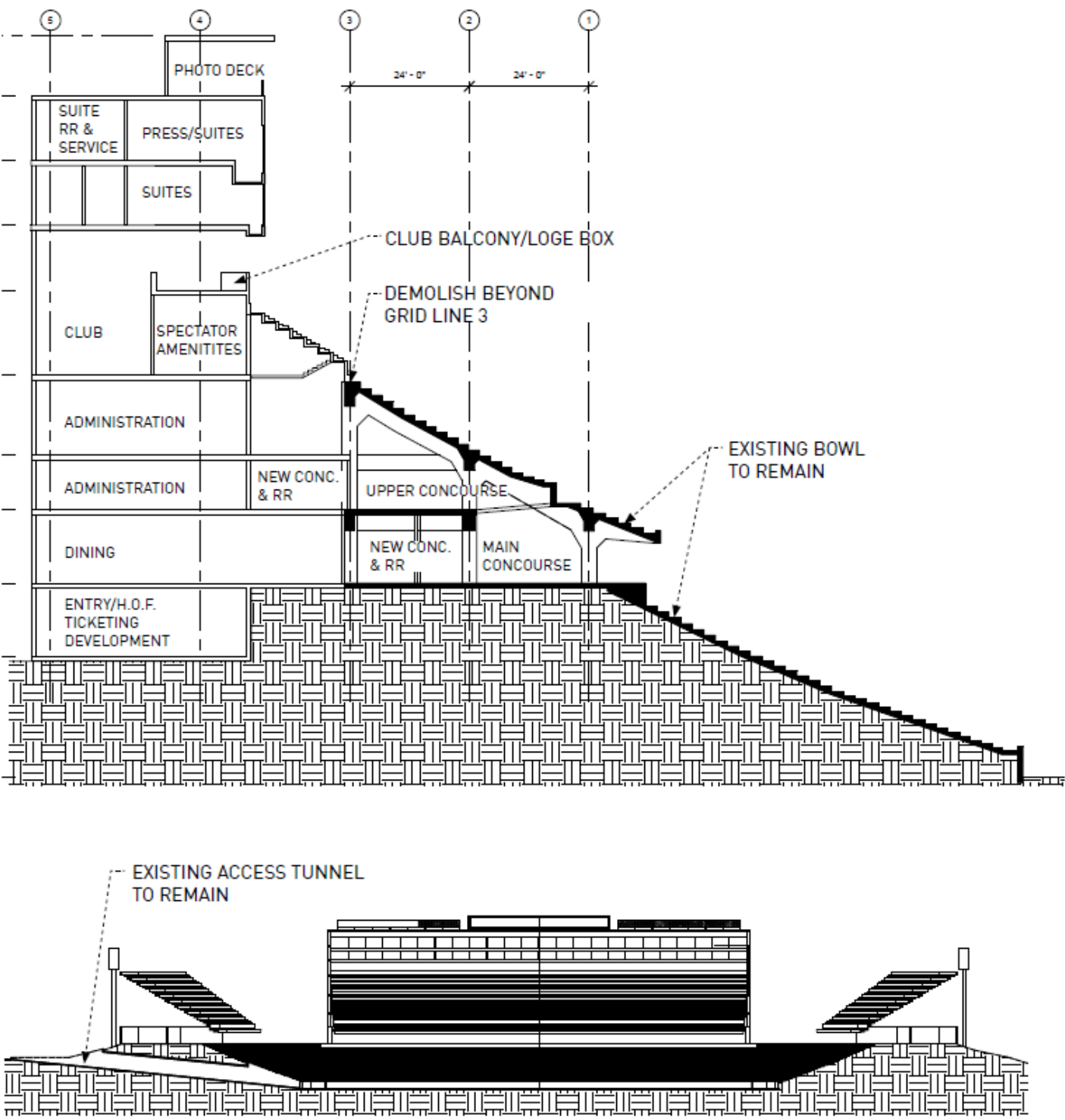
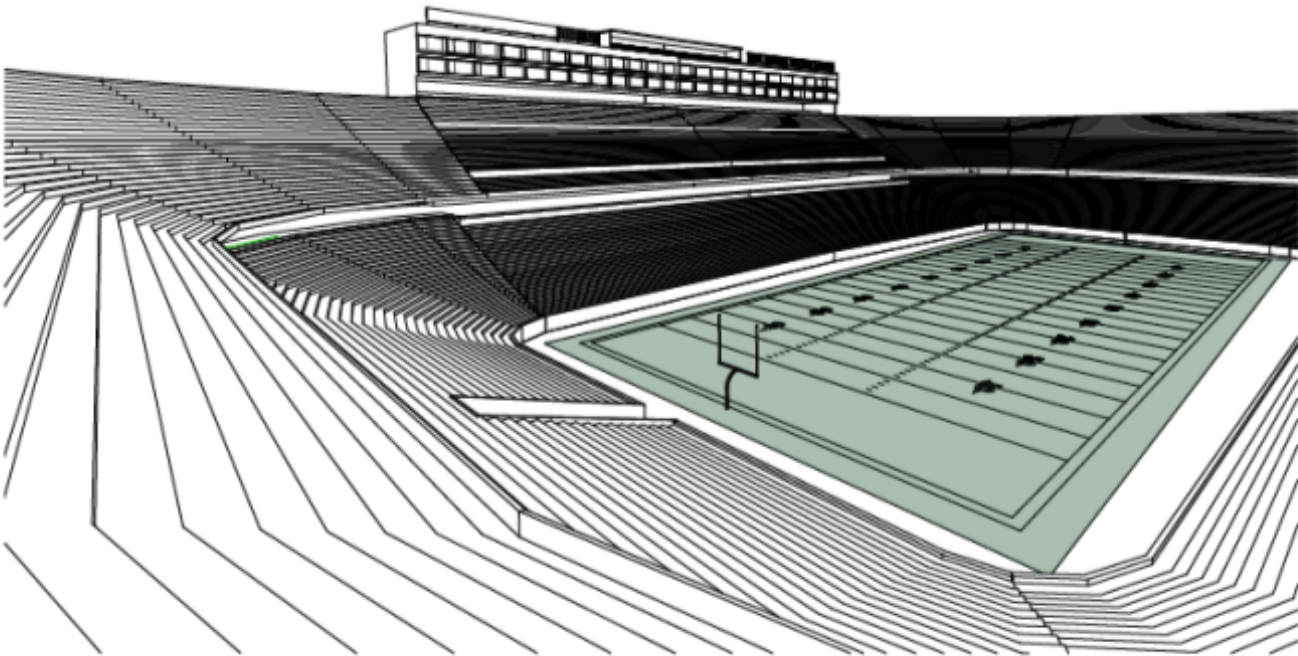
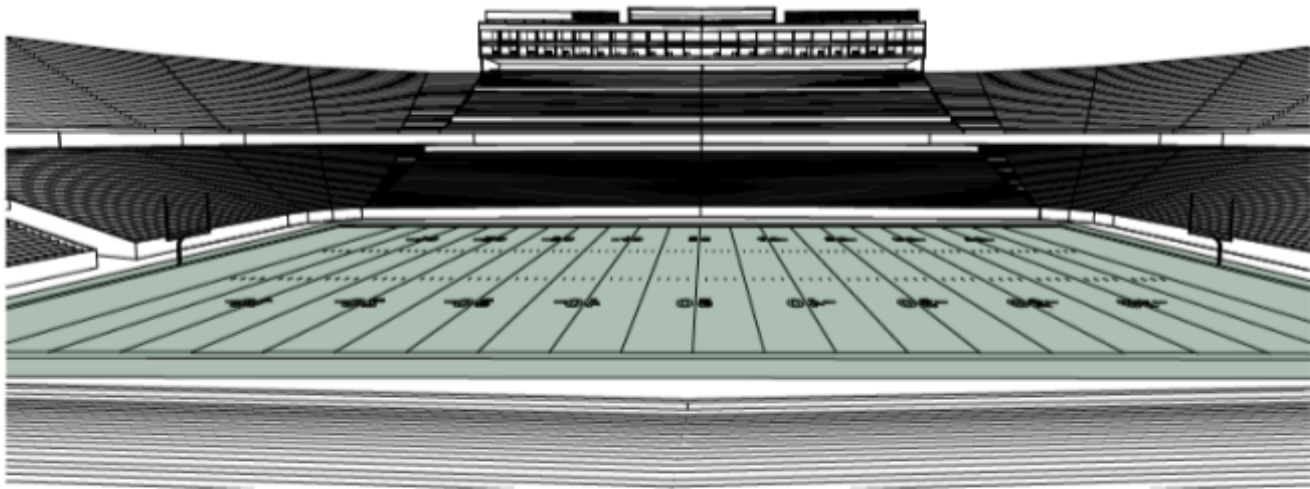



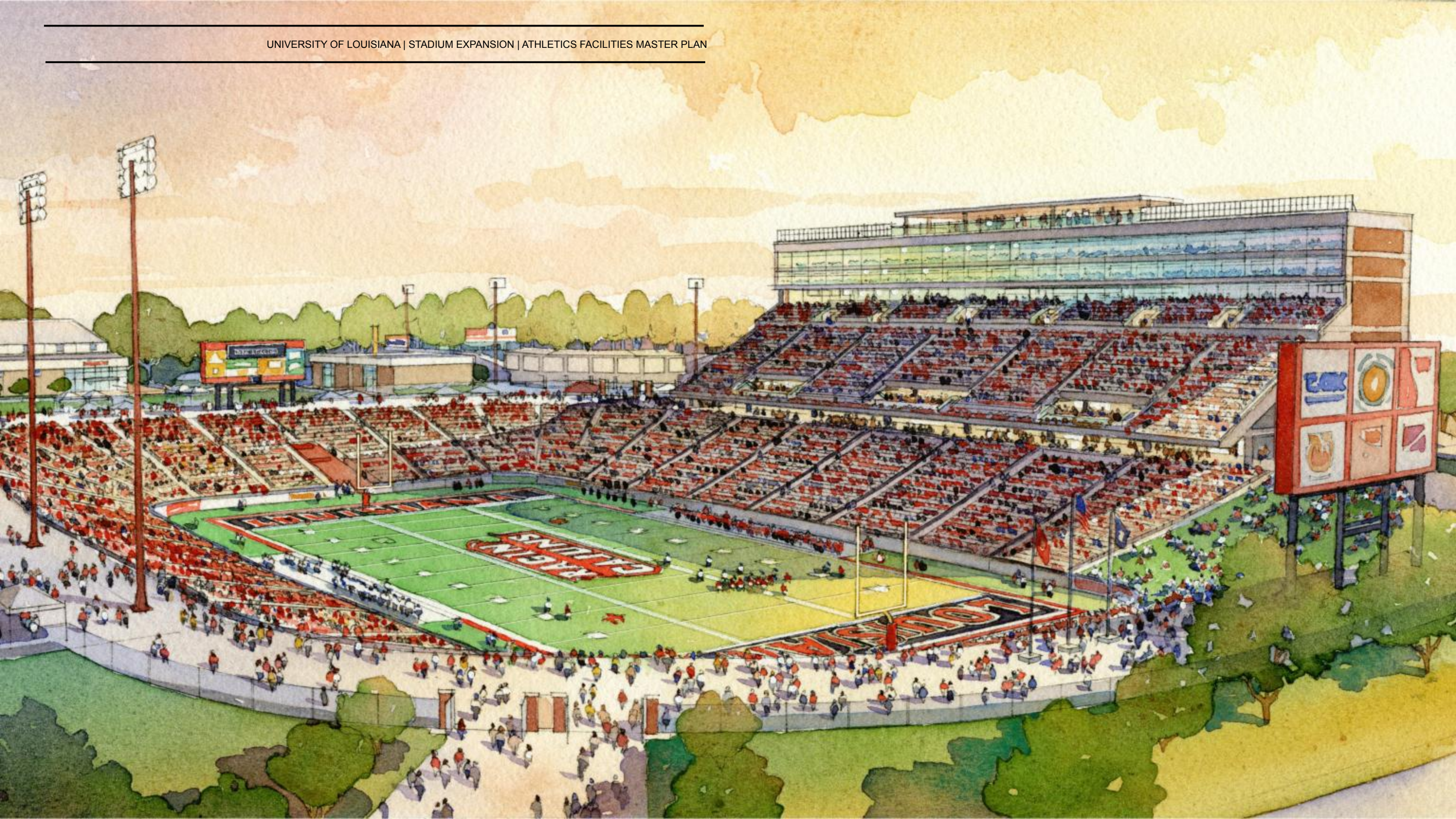



# CULOTTA TENNIS CENTER

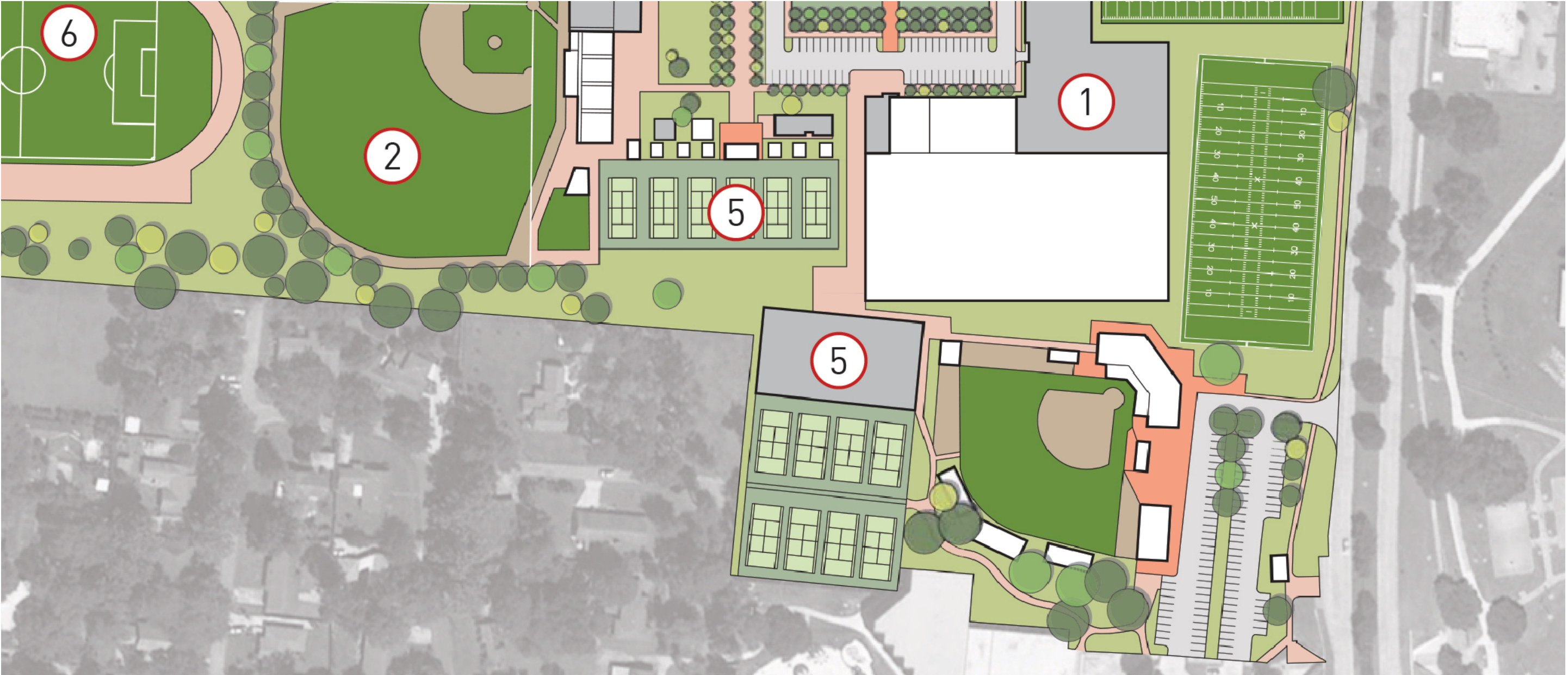



# CULOTTA TENNIS CENTER

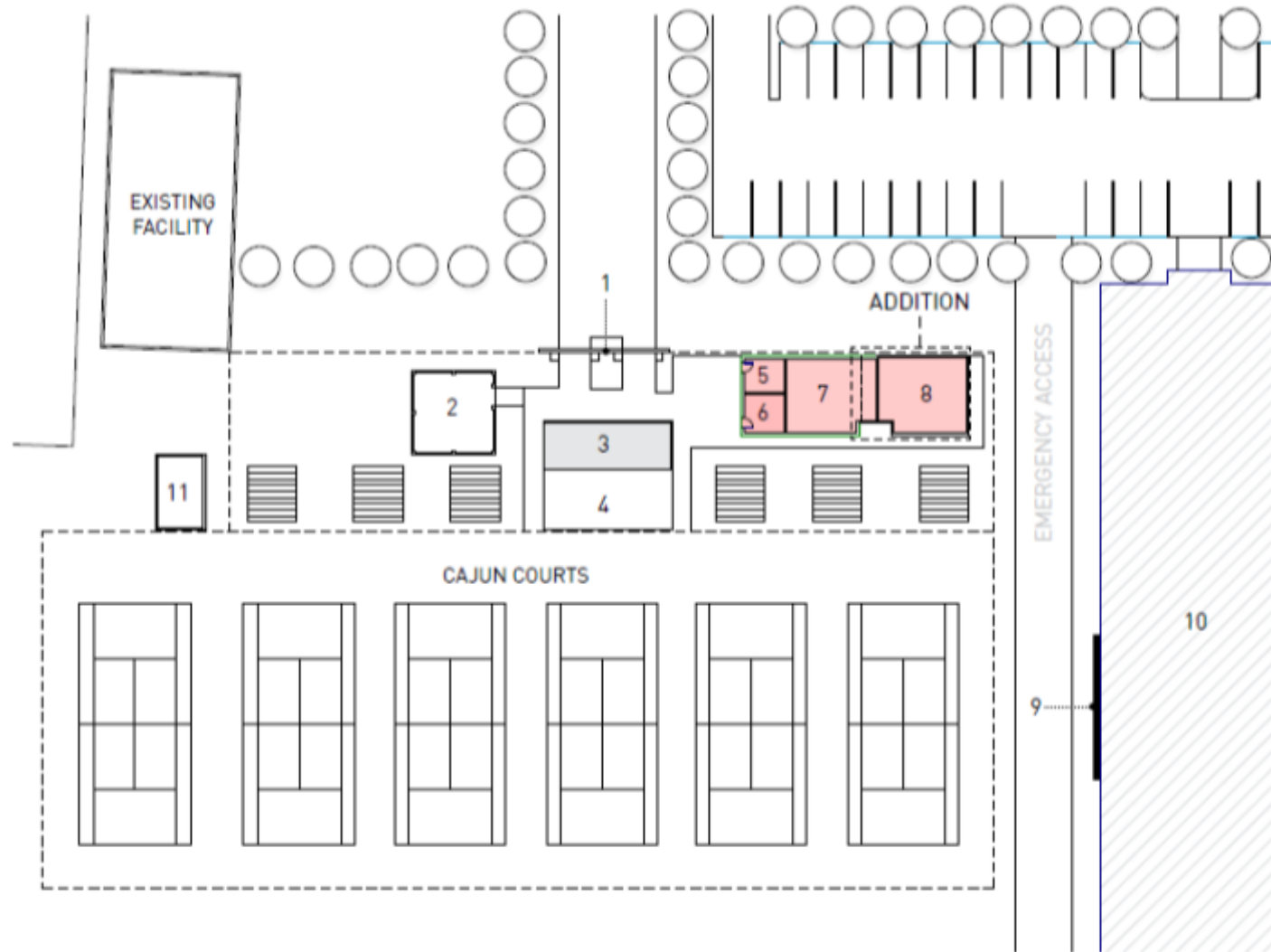

- Expanded team locker rooms
- New coaches offices
- New spectator amenities
- New team lounge and film room
- 4 indoor courts
- Lights

# TRACK + SOCCER FACILITY

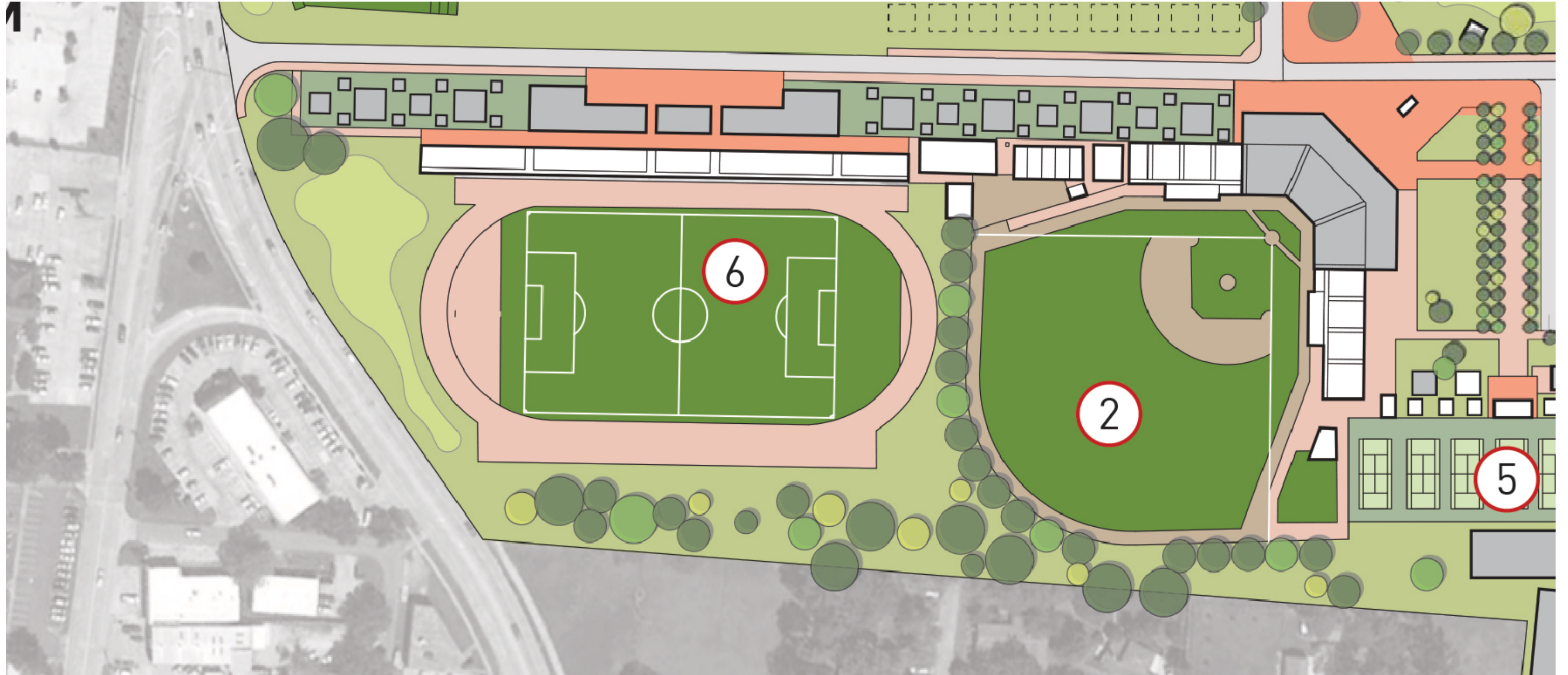



# TRACK + SOCCER FACILITY

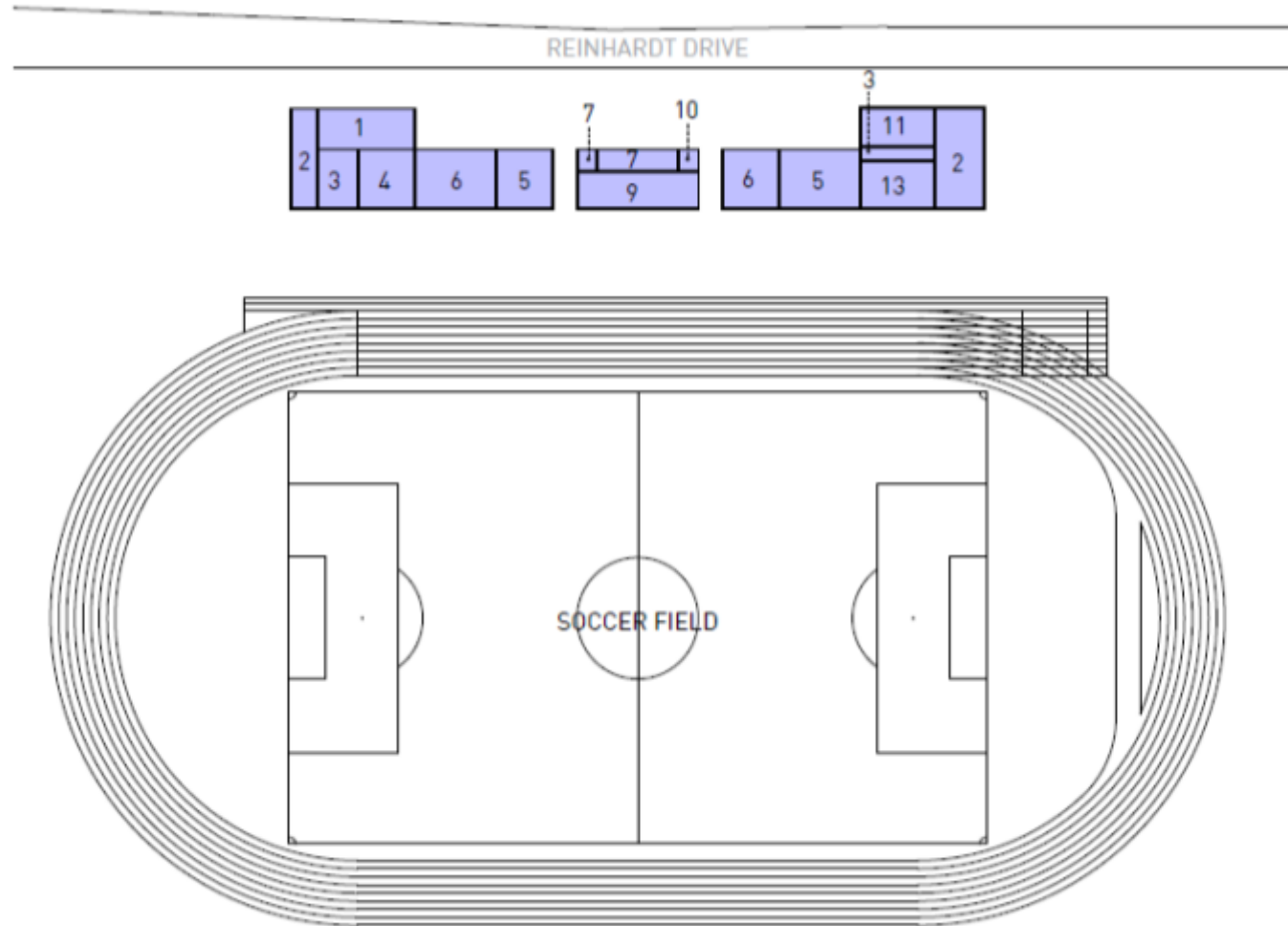

- New team lockers and training
- New coaches offices
- New spectator amenities
- New press box
- Expanded Lourdes Park



# EARL K. LONG GYMNASIUM



# EARL K. LONG GYMNASIUM

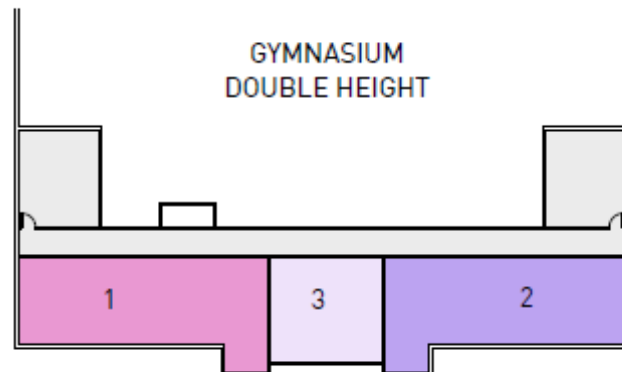
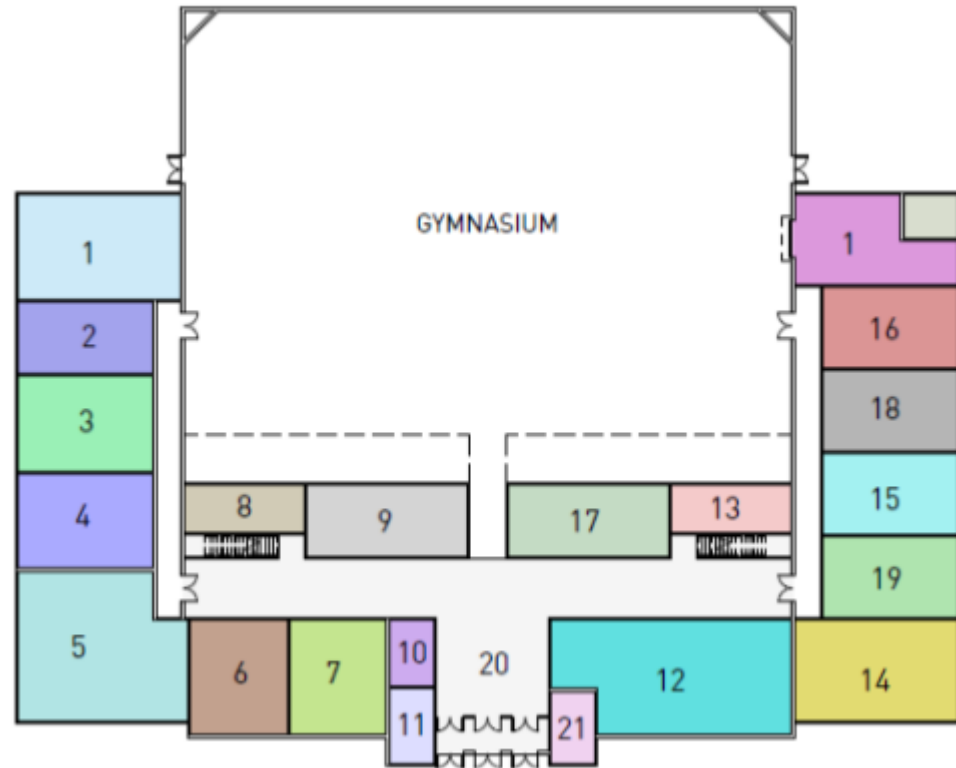

- New team lockers and training
- New coaches offices
- New spectator amenities
- Separate visitors and officials lockers
- Addition of sand volleyball planned



---

ATHLETICS DEPARTMENT  
FACILITIES MASTER PLAN

UNIVERSITY OF LOUISIANA  
*at Lafayette*

---

MARCH . 2013